

NOTES:

For good performance and safety, we recommend re-torquing all clamps and fasteners to the proper specifications after the first 500 miles and every 5000 miles thereafter.

Carrying high loads over rough roads with excess speed may damage the system on your truck. Exercise good judgement at all times.

Please call us with questions or concerns: 800.501.1587 or email: info@tracrac.com

ConTractor

ENGINEERED FOR PROFESSIONALS

Installation Manual



Trac Rac, Inc.
994 Jefferson Street • Fall River, MA 02721
800.501.1587
www.tracrac.com



SKU# 00-25850 Series

Contractor Rac Pro

Installation Notes:

- Contractor Rac Pro mounts onto the side rails of your truck without drilling.
- Installation is straight forward, and should take approximately 45 minutes to complete.

1. Verify that you have received the correct parts using the assembly drawing and packing list.

Figure 1. Contractor Rac Pro Installed on a truck bed.

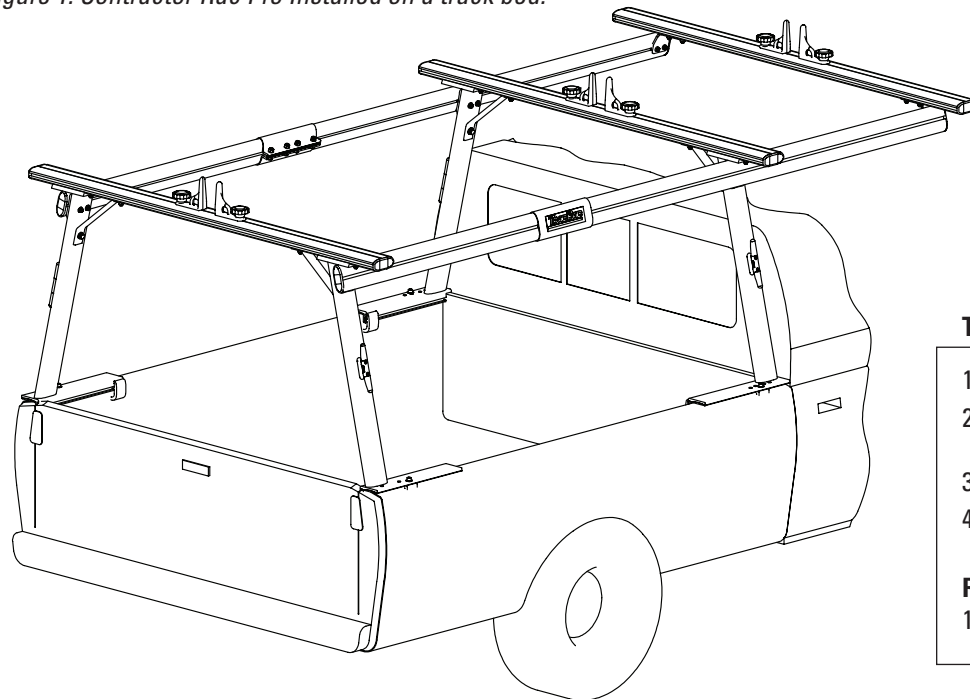

Table 1. Tools Required

- | |
|--------------------------------------|
| 1) Socket Wrench |
| 2) 13mm, 15mm, 16mm and 17mm Sockets |
| 3) 5mm Allen Wrench |
| 4) 3/16" and 5/16" Allen Wrench |
| Recommended |
| 1) Torque Wrench |

2. Install the cleat using two bolts (3/16" Allen Wrench). Loosely attach bottom of the corner braces to all four uprights using hex bolt (16mm socket).

Table 2. Cleat and Corner Brace Parts

Item No.	Qty.	Part No.	Description
1	1	PI-11009	Cleat
2	2	HD-80136	Bolt 1/4-20X1.75
3	1	01-22008	Corner Brace
4	1	HD-23143-1	Hex Bolt, M10-1.5X25
5	1	HD-23193	Heavy Washer, M10, THICK

Figure 2. Cleat and Corner Brace installation.

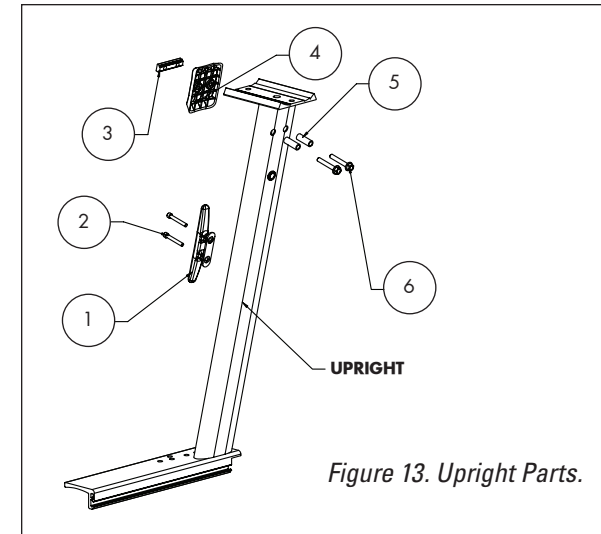
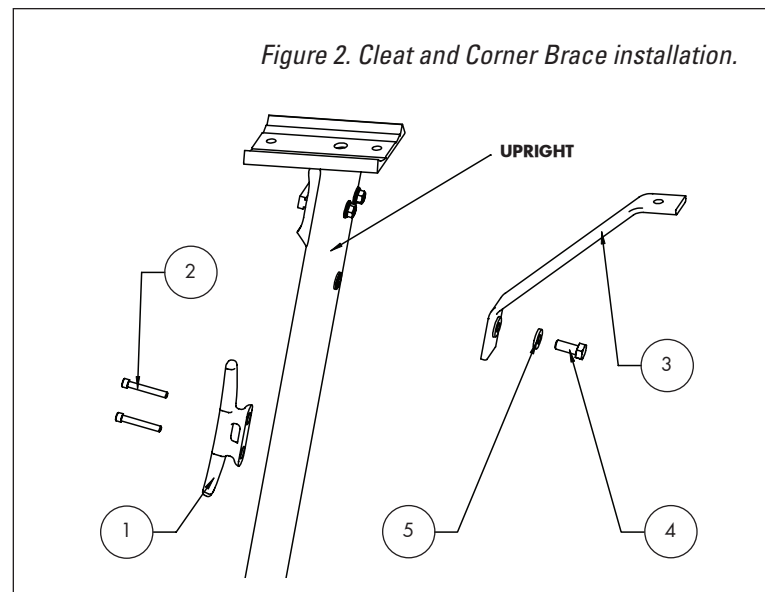

Figure 13. Upright Parts.

Table 8. Cantilever Clamp Part Reference

Item No.	Qty.	Part No.	Description
1	1	01-11144	Cantilever Clamp
2	1	BL-22000-D	Label, TracRac
3	1	HD-23179	Lock Nut M10X1.5
4	4	HD-23165	Bolt, M10X1.5, 35mm Hex

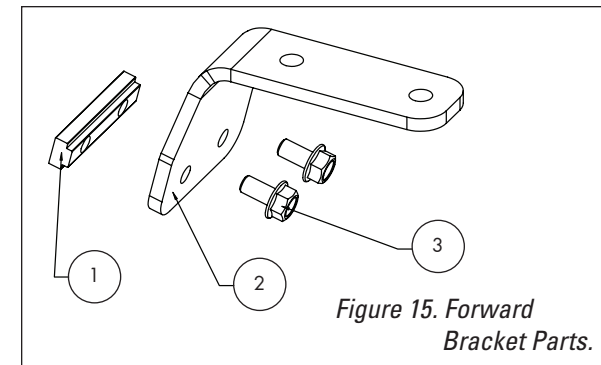

Figure 15. Forward Bracket Parts.

Table 9. Forward Bracket Part Reference

Item No.	Qty.	Part No.	Description
1	1	FX-11139	Nut Bar
2	1	01-11142	Bracket, Forward
3	2	HD-23163	Bolt, M8X1.25, 16mm Hex Flange

NOTES: Although the Contractor Rac is capable of carrying a maximum of 1250 lbs, evenly distributed between both racks, the capability is limited to the strength of the truck sidewall it is mounted on. More information on back cover.

Table 7. Upright Part Reference

Item No.	Qty.	Part No.	Description
1	1	PI-11009	Cleat
2	2	HD-80136	Bolt 1/4-20X1.75"
3	1	FX-11139	Nut Bar
4	1	PI-23327	Spacer, Cantilever
5	2	FX-90138	Bushing, Oval Tube
6	2	HD-23163-1	Hex Flange Bolt, M8X1.25, 50mm

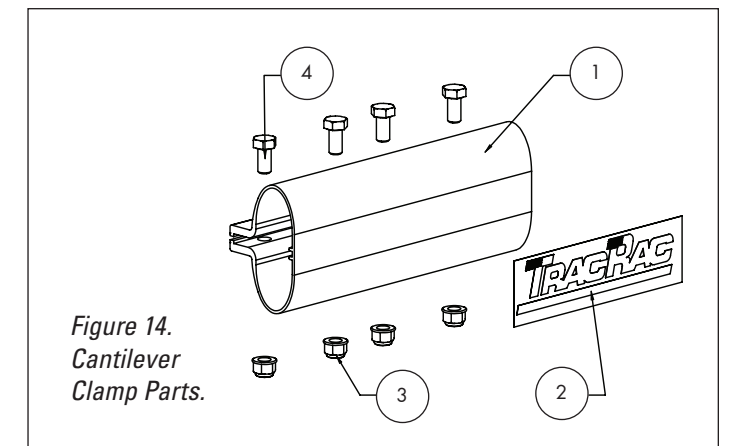

Figure 14. Cantilever Clamp Parts.

Figure 16. Tie Down Kit.

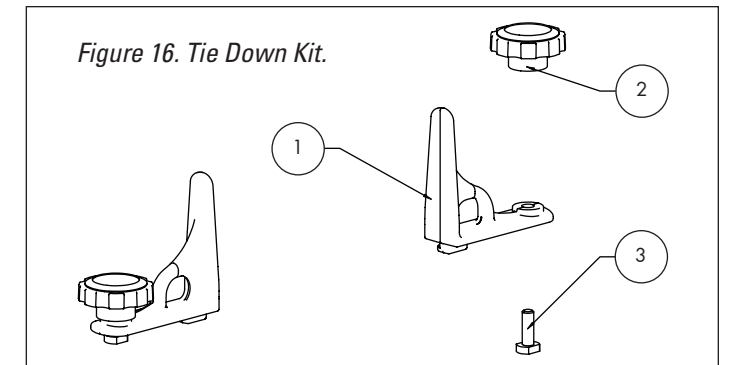

Table 10. Tie Down Kit Part Reference

Item No.	Qty.	Part No.	Description
1	2	10-25111	Tie Down Zinc Diecast
2	2	KB-90004	Knob, Female 3/8-16 UNC
3	2	HD-80122	T-Bolt #3/8-16X1-1/8, SS

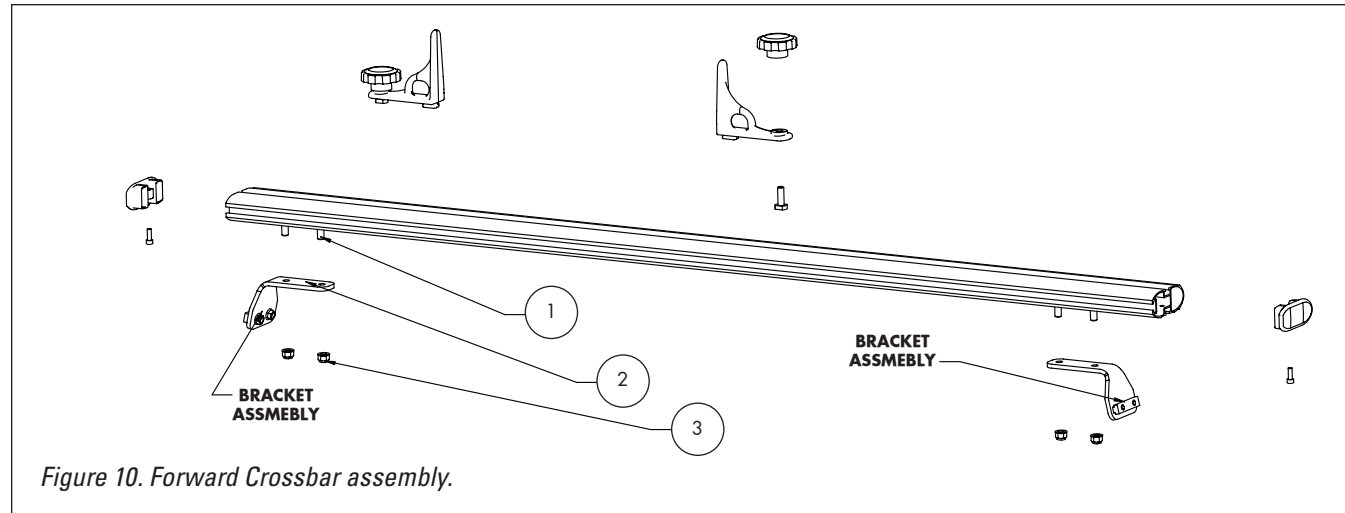

Figure 10. Forward Crossbar assembly.

Table 6. Forward Crossbar assembly parts

Item No.	Qty.	Part No.	Description
1	4	HD-80218	T-Bolt, M10-1.5X25
2	2	01-25051	Bracket, Forward
3	4	HD-23179	Lock Nut #10-1.5

10. Built forward crossbar assembly by following the steps of the standard crossbar assembly except slide 4 bolts (item 1) into bottom groove of the crossbar (2 per side). Attach the end caps. Loosely attach the bracket assemblies to the crossbar using lock nuts and 15mm socket.

11. Loosen two bolts (13mm socket) on the forward bracket assemblies. Slide the nut bar into the cantilever groove on each side.

12A. Align the bracket with the end of the front cantilever.

12B. Tighten two bolts using 13mm socket (**Torque 90-110 lbs**).

12C. Tighten two nuts using 15mm socket (**Torque 220-240 lbs**) on each side.

12D. Press the end caps into the front and rear cantilevers.

Make sure that all bolts and nuts are tightened up.

Assembly is completed.

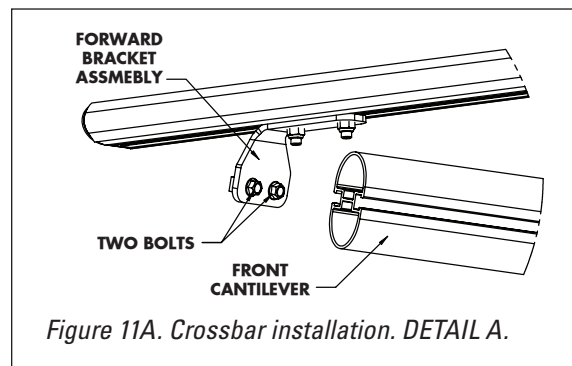

Figure 11A. Crossbar installation. DETAIL A.

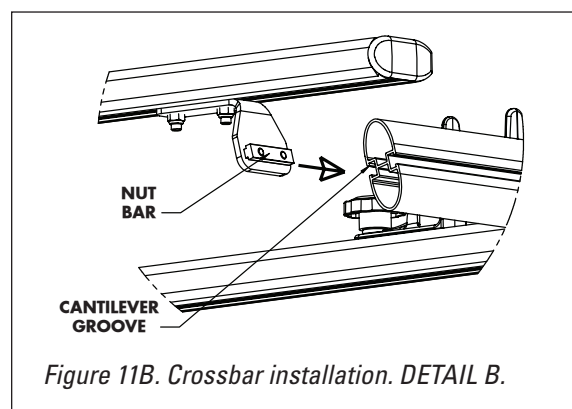

Figure 11B. Crossbar installation. DETAIL B.

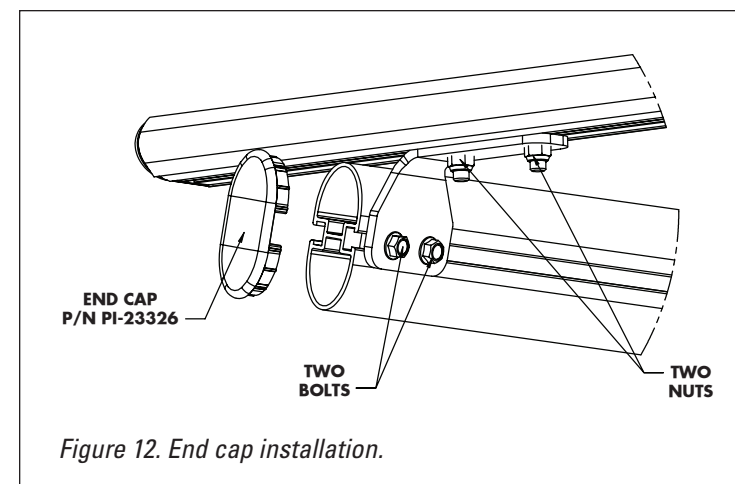

Figure 12. End cap installation.

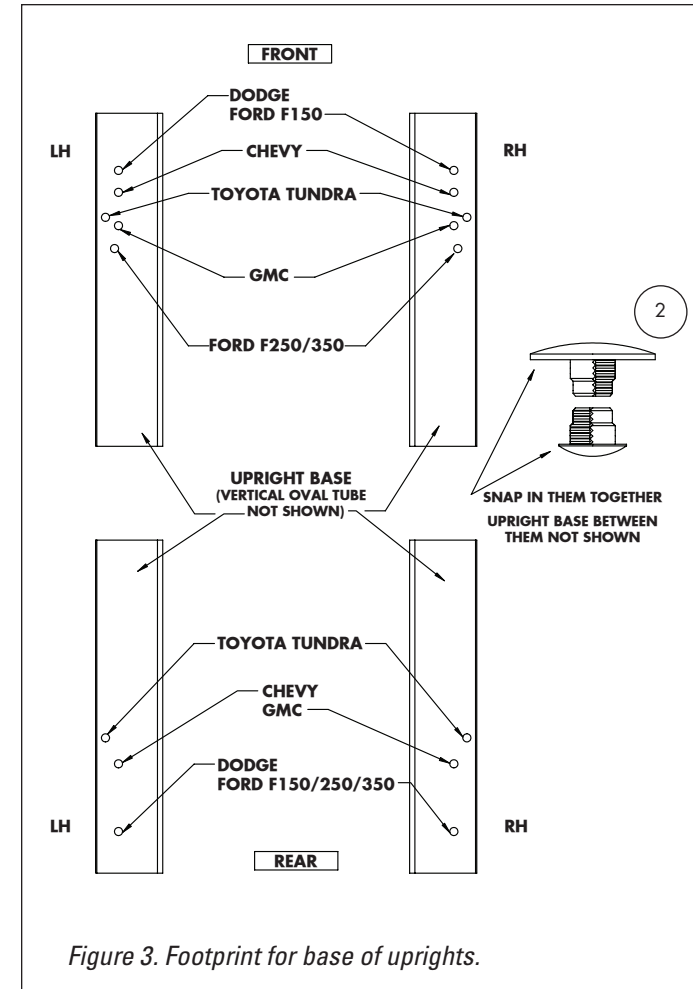

Figure 3. Footprint for base of uprights.

Table 4. Upright Assembly Parts

Item No.	Qty.	Part No.	Description
1	4	HD-11011	Bolt Socket Head Cap, 3/8-16x3.00"
2	2	HD-80078	3/8 Washer, THIN
3	2	RX-11031	Rubber Block
4	2	01-2100N	Sq Pocket Nut, Brass
5	1	FX-23269	Rubber Shim, Front LH
6	1	FX-23270	Rubber Shim, Front RH
7	1	FX-23271	Rubber Shim, Rear LH (Not Shown)
8	1	FX-23272	Rubber Shim, Rear RH (Not Shown)
9	2	01-23222	Clamp, L-Rail
10	2	01-22911	U-Channel 3" Long

3. After selecting the correct hole pattern for your truck (using Figure 3), plug up all other holes using the black plastic rivets. Large rivet—on the top, small rivet—on the bottom (Figure 4).

Table 3. Plastic Rivets

Item No.	Qty.	Part No.	Description
1	15	PI-23328	Rivet, Small, Ratchet, Black
2	15	PI-23329	Rivet, Large, Ratchet, Black

4. Attach rubber block assembly and rubber shim to uprights using socket head cap bolt, washer, rubber shim, rubber block and brass square pocket nut, see Figure 4. Complete all four upright assemblies. Do not attach the L-Rail clamps (items 1,9 and 10), see Figure 5. **NOTE: Match the hole patterns in the rubber shims to the correct upright. Flat surface of rubber shim must face down.**

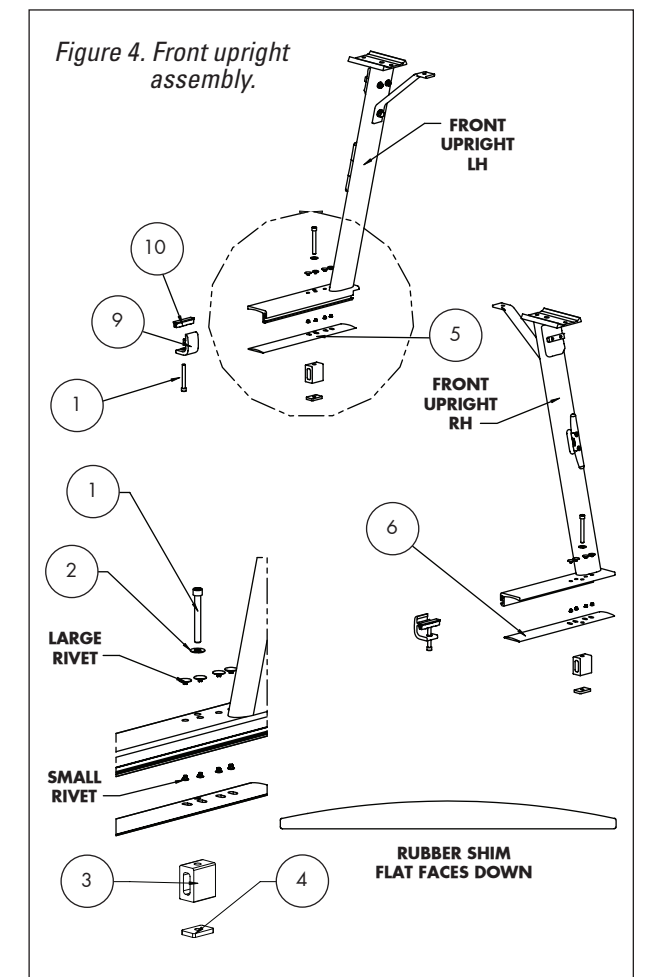
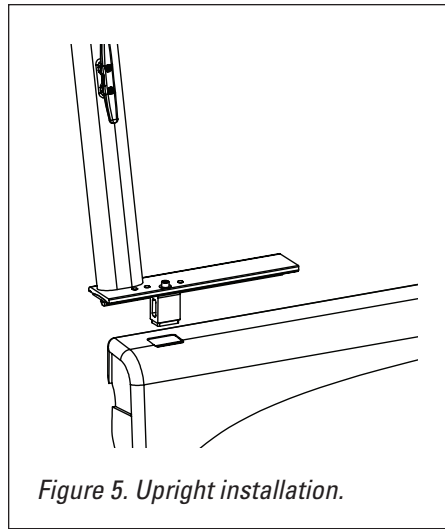

Figure 4. Front upright assembly.



5. Insert the rubber block into the stake pocket opening and tighten up the bolt using 5/16 Allen Wrench. **Torque to 90-110 in-lbs.**
6. Slide one clamp into the base of each upright. Position as shown and secure using socket head cap bolt and U-channel. Tighten up the bolt using 5/16 Allen Wrench. **Torque to 130-150 in-lbs.**
- 7A. Build two standard crossbar assemblies. Assemble two tie downs—items 1, 2 and 3 (See Figure 7 and Table 5). Slide them into the top groove of the crossbar.
- 7B. Slide 6 T-bolts (item 5) into the bottom groove of the crossbar (3 per side).
NOTE: The flat recess of the crossbar must face down.
- 7C. Attach the end caps (item 6) using screws (item 7) using 5mm Allen Wrench.

Figure 5. Upright installation.

Table 5. Standard Crossbar Assembly

Item No.	Qty.	Part No.	Description
1	2	10-25111	Tiedown
2	2	KB-90004	Knob, Female 3/8-16 UNC
3	2	HD-80122	T-Bolt 3/8-16X1-1/8, SS
4	1	01-10540	Crossbar, Triple T-Slot
5	6	HD-80218	T-Bolt, M10X1.5, 25mm
6	2	PI-23325	Crossbar Endcap
7	2	HD-23276	Bolt M6X1

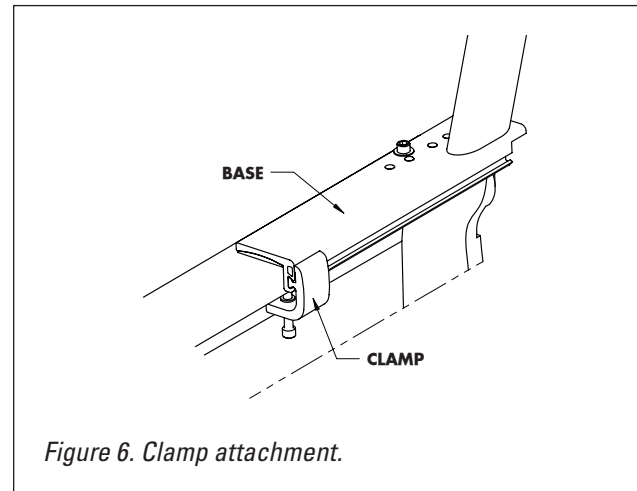

Figure 6. Clamp attachment.

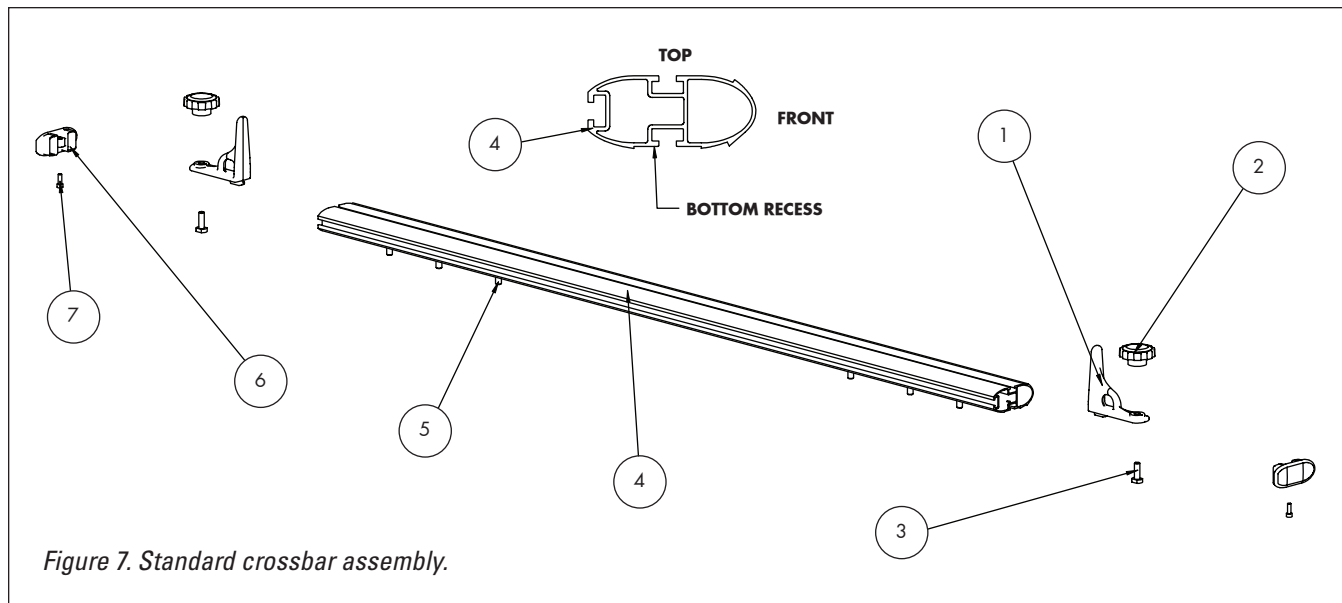

Figure 7. Standard crossbar assembly.

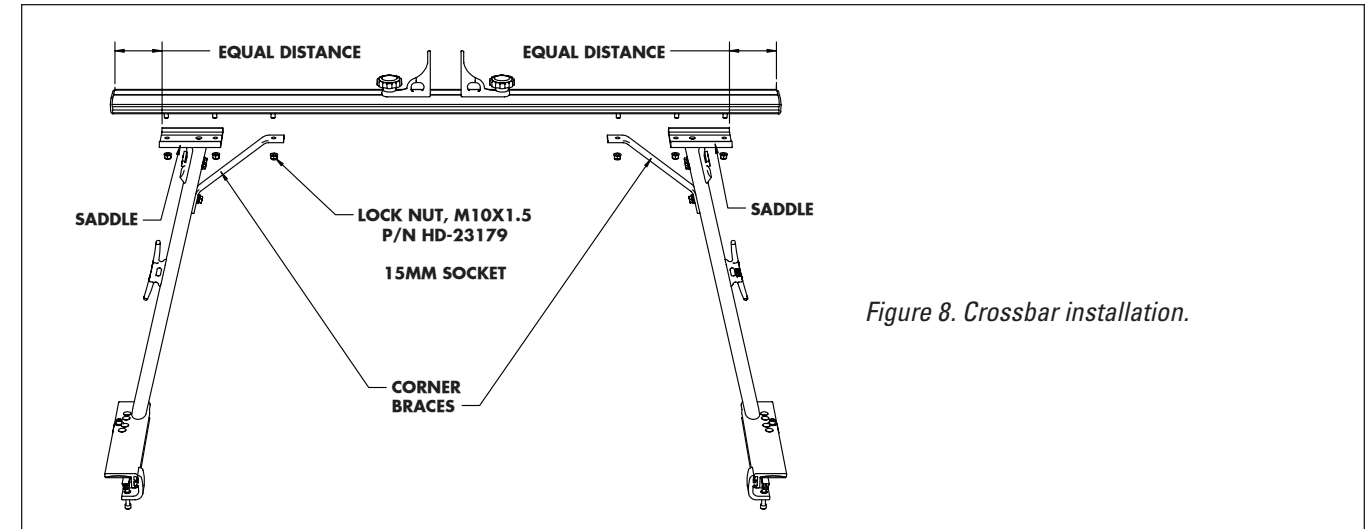

Figure 8. Crossbar installation.

- 8A. Attach each crossbar onto a left and right upright by inserting the T-bolts through the saddle plate and corner brace holes. Attach 6 locknuts leaving them loose for adjustments.
- 8B. Center the crossbar left to right. Crossbar should fit flat on the saddle plates, tighten the T-bolt nuts using 15mm socket.
Torque T-bolt nuts to 220-240 in-lbs.
9. Follow steps 1 through 6 (See Figure 9) to install the front and rear cantilevers.

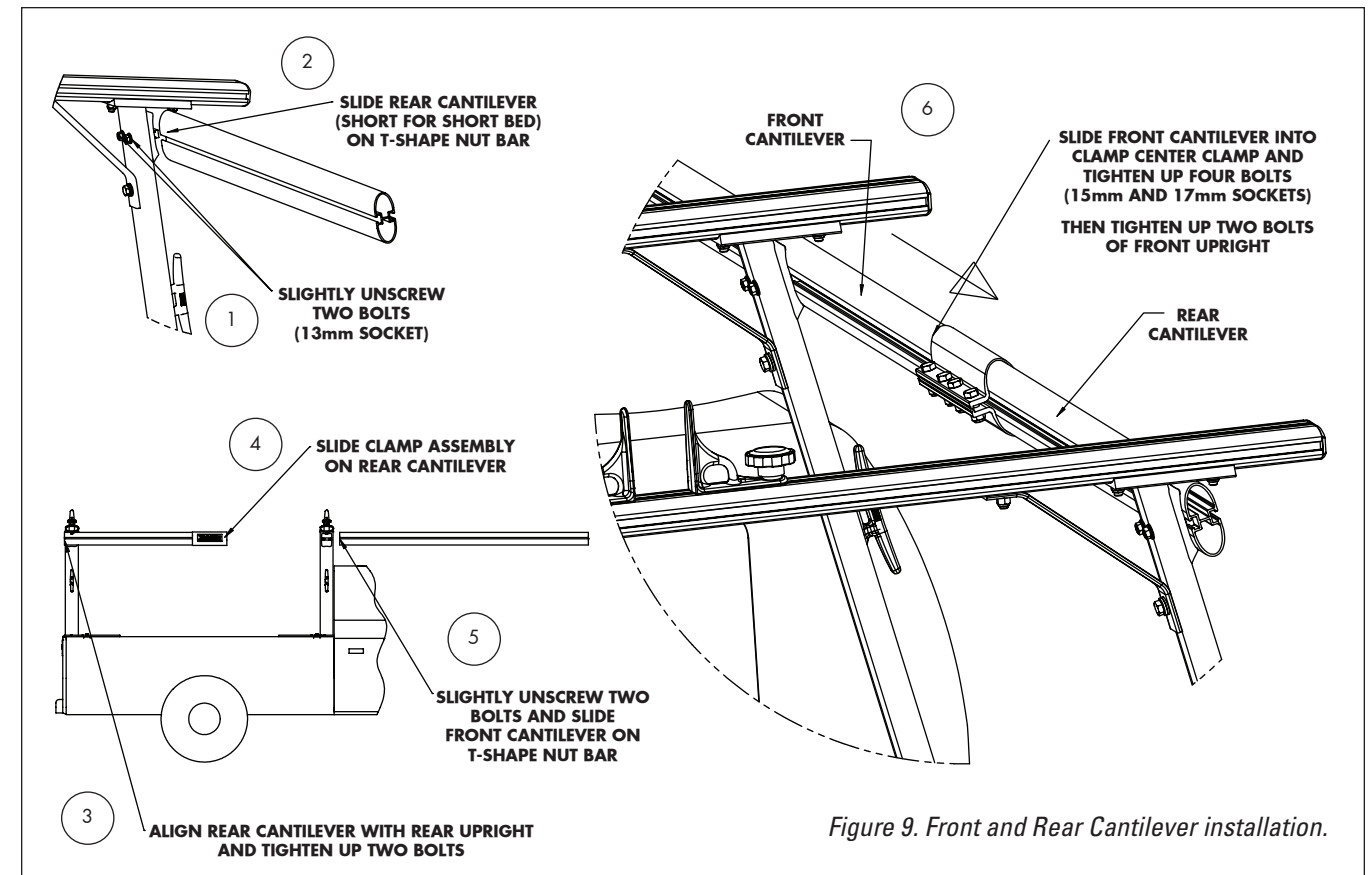

Figure 9. Front and Rear Cantilever installation.